



570.14 B



DRES.G12R.05-8B



571.14 B

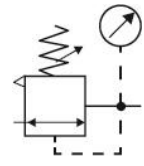

Stainless steel regulators containing no non-ferrous metals for use in the food processing, chemical, mining, plant construction and special machinery industries as well as in the medical technology.

Medium temperature max.	80 °C
Ambient temperature max.	80 °C
Housing	Stainless steel 1.4404 (AISI 316L)
Sealant	FKM
Diaphragms	PTFE on NBR carrier
Flow rate measurement	at $P_1 = 8$ bar, $P_2 = 6$ bar and pressure drop $\Delta p = 1$ bar

Reversible, stainless steel pressure regulator with self-relieving design, stainless steel pressure gauge

Art. No.	Type No.	Thread	Max. input pressure bar	Control range bar	Flow rate l/min	A mm	B mm	C mm	D mm
101191	570.14 B	G 1/4	30	0,5 - 8	1300	64,0	160,0	37,0	122,0
101192	570.14 D	G 1/4	50	1 – 15	1300	64,0	160,0	37,0	122,0
129270	DRES.G12R.05-8B	G 1/2	50	0,5 – 8	2800	109,0	160,0	39,0	121,0
129271	DRES.G12R.1-15B	G 1/2	50	1 – 15	2800	109,0	160,0	39,0	121,0

Non-reversible, stainless steel pressure regulator, for liquid media, without self-relieving design, stainless steel pressure gauge

Art. No.	Type No.	Thread	Max. input pressure Bar	Control range Bar	Flow rate l/min	A mm	B mm	C mm	D mm
101195	571.14 B	G 1/4	30	0,5 - 8	1300	64,0	160,0	37,0	122,0
101196	571.14 D	G 1/4	50	1 – 15	1300	64,0	160,0	37,0	122,0
129272	DRES.G12NR.05-8B	G 1/2	50	0,5 – 8	2800	109,0	160,0	39,0	121,0
129273	DRES.G12NR.1-15B	G 1/2	50	1 – 15	2800	109,0	160,0	39,0	121,0

- NPT thread available on request
- Other control ranges, temperature ranges and FDA approval available on request

Dimensions:

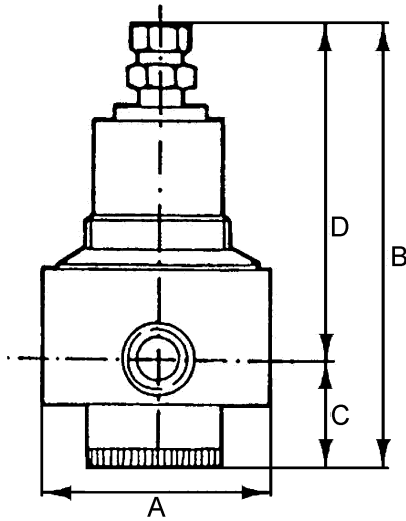

- Any liability is excluded in case of use of harmful and explosive media

- Feedback pressure regulators not suitable for liquid media

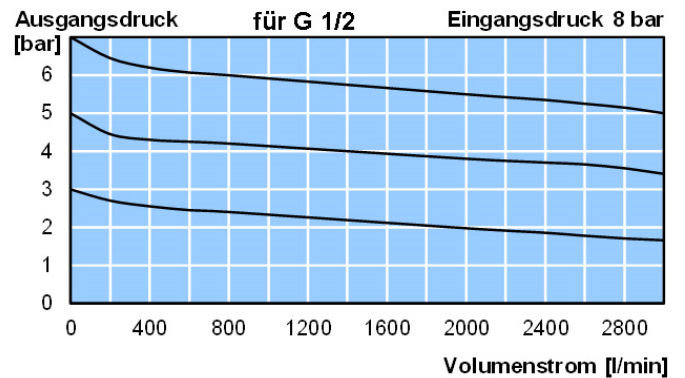
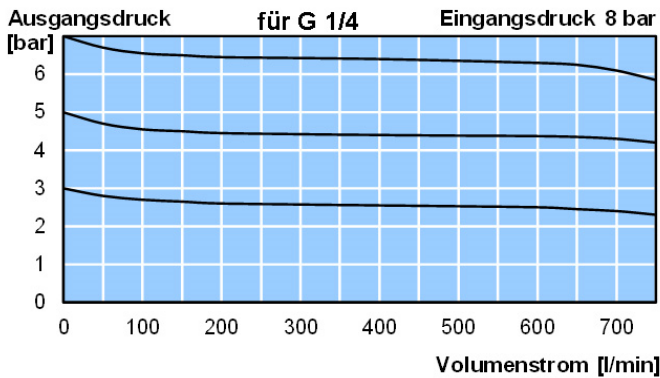

Accessories / spare parts

Art. No.	Type No.	Description
101199	576/1	Mounting bracket with nut M45x1.5
101200	576/3	Mounting bracket with nut M50x1.5
101201	4084	Pressure gauge Ø 63 mm, G 1/4 ET, 0 – 10 bar
101202	4085	Pressure gauge Ø 63 mm, G 1/4 ET, 0 – 16 bar
101203	22.5704.4	Set of wearing parts for G 1/4 (reversible)
194360	VTSDR14R50	Set of wearing parts for G 1/4 (reversible)
129671	VTSDRES.G12.RÜ	Wear part set, stainless steel pressure regulator G 1/2 (revers.)
101205	22.5714.4.16	Set of wearing parts with PTFE diaphragm for G 1/4 (non-re.)
194362	VTSDR1450	Set of wearing parts with PTFE diaphragm for G 1/4 (non-re.)
129672	VTSDRES.G12	Wear part set, stainless steel pressure regulator G 1/2 (n. revers.)